

TYPICAL PLAN VIEW

LONGITUDINAL TRENCHING THROUGH STRIP PATH AND UNSURFACED AREAS

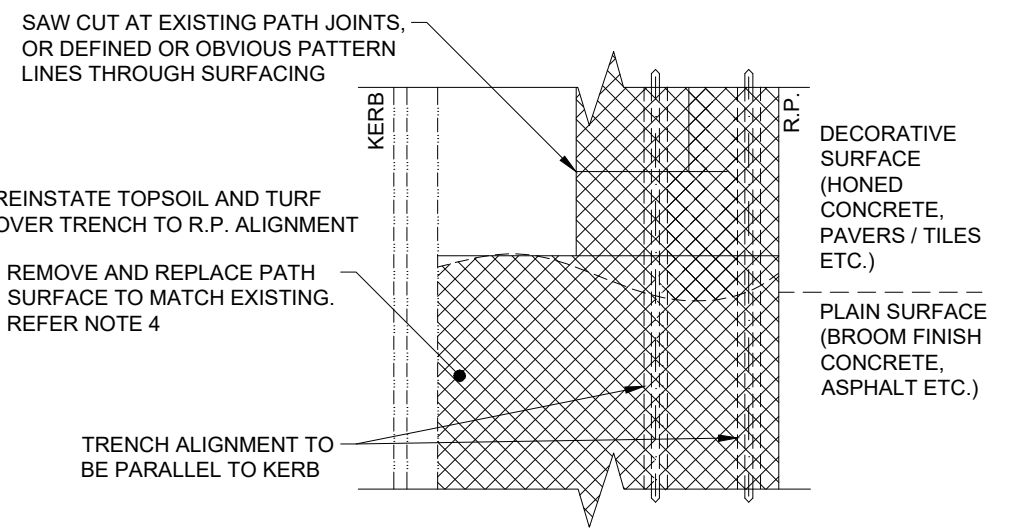

TYPICAL PLAN VIEW

LONGITUDINAL TRENCH THROUGH FULL WIDTH PATH

VERGE WITH FULL WIDTH CONSTRUCTED PATH

(LONGITUDINAL TRENCH SHOWN. APPLY SAME REQUIREMENTS FOR TRANSVERSE TRENCHING)

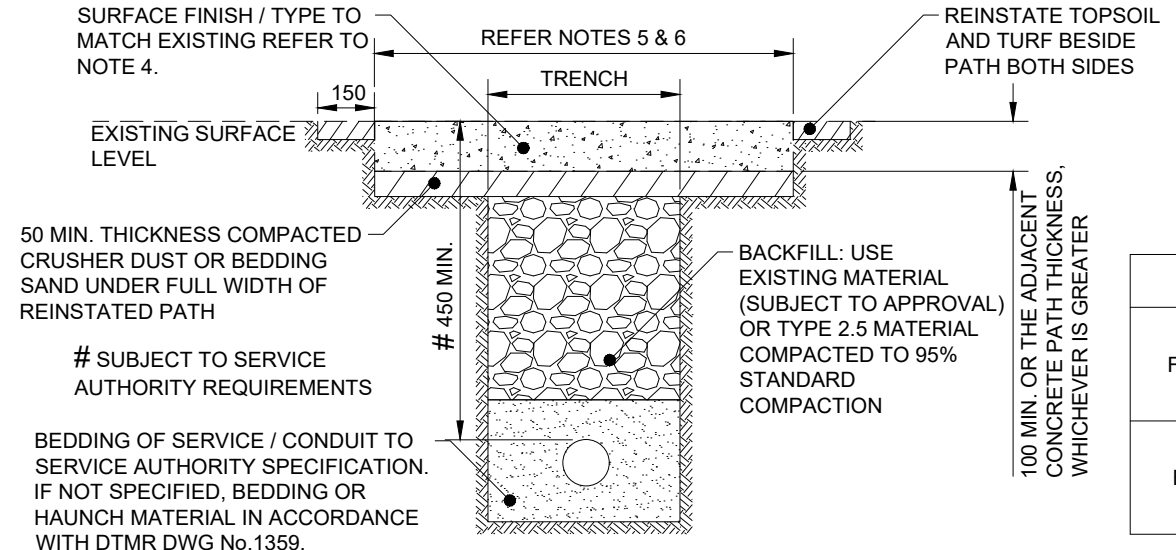

UNSEALED LAND WITH STRIP CONSTRUCTED PATH

(LONGITUDINAL TRENCH SHOWN. APPLY SAME REQUIREMENTS FOR TRANSVERSE TRENCHING)

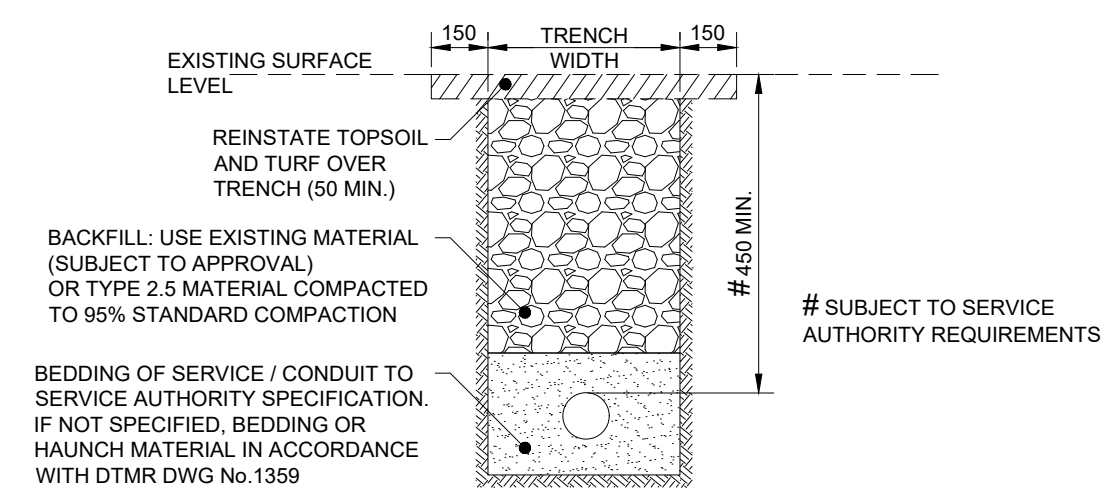

UNSEALED LAND (NO CONSTRUCTED PATH)

(TRANSVERSE TRENCH SHOWN. APPLY SAME REQUIREMENTS FOR LONGITUDINAL TRENCHING)

TABLE 1 - ASPHALT SURFACE

LOCATION	DTMR	ASPHALT THICKNESS	
		EACH LAYER	TOTAL
FOOTPATHS	DG7	15 - 20 mm	MIN. 25mm OR THE ADJACENT ASPHALT THICKNESS, WHICHEVER IS GREATER
BIKEPATHS	DG7 OR DG10	15 - 20 mm (TYPE 1) 25 - 40 mm (TYPE 2)	MIN. 25mm OR THE ADJACENT ASPHALT THICKNESS, WHICHEVER IS GREATER

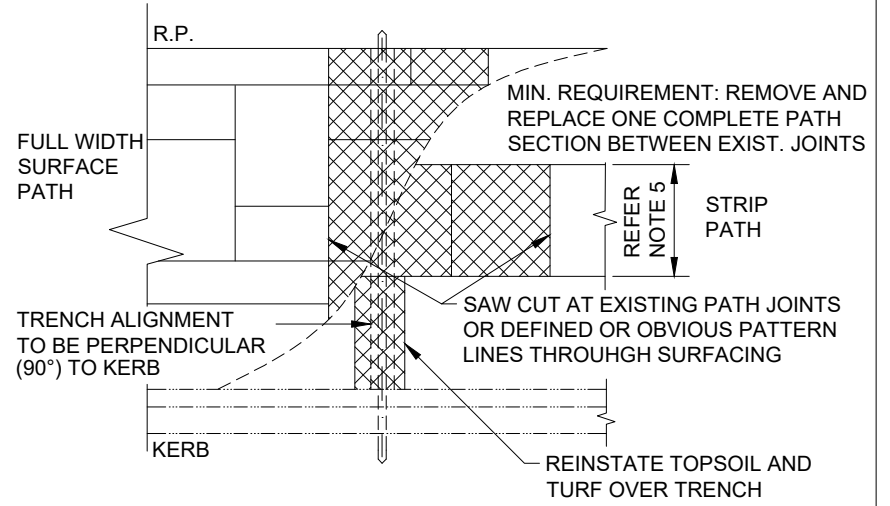

TYPICAL PLAN VIEW

TRANSVERSE TRENCH ACROSS VERGE

NOTES:

- TRENCHLESS TECHNOLOGY TECHNIQUES ARE THE PREFERRED METHOD FOR ROAD CROSSING SERVICES CONDUITS IN EXISTING VERGES.
- THE VERTICAL DEVIATION FROM A 1200 LONG STRAIGHT EDGE (IN ALL DIRECTIONS), IS NOT TO EXCEED 5mm.
- SURFACE REPAIRS ARE TO BE UNDERTAKEN WITHIN 24 HOURS UNLESS APPROVED OTHERWISE BY COUNCIL.
- WHERE THE TRENCH HAS BEEN CONSTRUCTED LONGITUDINALLY IN THE VERGE, THE FINAL SURFACE REPAIRS WIDTH IS TO MATCH THE EXISTING SURFACE WIDTH (e.g. 1.5m, FULL WIDTH etc.). FOR CENTRAL BUSINESS DISTRICT AND STRIP FOOTPATHS REFER TO RELEVANT MRC STANDARD DRAWINGS.
- WIDTH OF STRIP PATH REINSTATEMENT:
 - IF REINSTATEMENT IS LESS THAN 10m LONG: REINSTATE TO MATCH WIDTH OF EXISTING STRIP PATH (1000 MIN.);
 - IF REINSTATEMENT IS GREATER THAN 10m LONG; REINSTATE FULL WIDTH PATH.
- THIS STANDARD DRAWING TO BE READ IN CONJUNCTION WITH SPECIFICATIONS MRS03, MRS04, MRS05, MRS07B, MRS08, MRS11, MRS30, MRS39, MRS91, MRC ANNEXURES AND SUPPLEMENTARY SPECIFICATIONS.
- FOR TRENCH RESTORATION FOR STORMWATER DRAINAGE PIPES, REFER TO DTMR STD DWG No.1359 FOR NEW ROAD CONSTRUCTION OR MRC DWG No. A3-00898 FOR INSTALLATION IN EXISTING ROADWAYS. FOR TRENCH RESTORATION FOR TRAFFIC SIGNAL CONDUITS, REFER TO DTMR STANDARD DRAWING NUMBER 1149.
- ALL DIMENSIONS IN MILLIMETRES (U.N.O).

DATE	DESCRIPTION	APPVD
C 16.05.16	DRAWING LOCATION AMENDED	
B 18.03.16	REVISED FORMAT AND TITLEBLOCK	GH
A -	ORIGINAL ISSUE	-

SURVEY	DRAWN	SIGNED	DATE
-	-	-	-
SURVEY FILE No	DESIGNED	SIGNED	DATE
-	-	-	-
LEVEL DATUM	CHECKED	SIGNED	DATE
-	-	-	-
MERIDIAN	MANAGER TECHNICAL SERVICES		
-	ORIGINAL SIGNED BY	22.02.13	DATE
-	G. HAWES RPEQ 5693		

DIRECTOR ENGINEERING AND COMMERCIAL INFRASTRUCTURE

ORIGINAL SIGNED BY G.HAWES
JASON DEVITT

DATE 22.02.13

Mackay
REGIONAL COUNCIL

STANDARD
UTILITY TRENCH RESTORATION
VERGES AND PATHS

SHEET 1 OF 1	
WORKS JOB No. -	
DRAWING No. A3-00900	AMEND. C