

PROVIDE CONTROL JOINTS EVENLY SPACED ALONG FOOTPATHS LENGTH. MAXIMUM 3.0m CENTRES.

**PLAN**  
SCALE 1:25

PROVIDE EXPANSION JOINT AT EVERY 3<sup>rd</sup> JOINT. MAXIMUM 9.0m CENTRES.

300mm LONG Y12 DOWELS AT 300 CENTRES

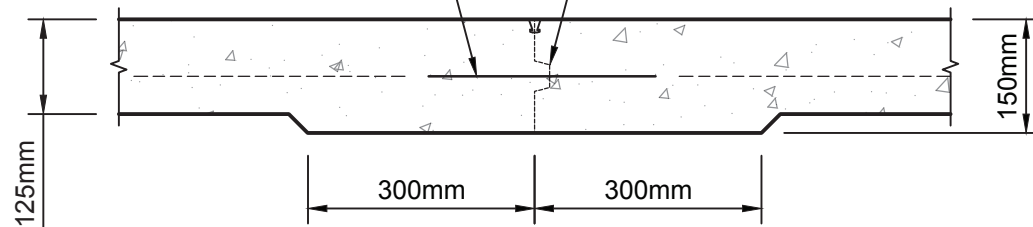

**TYPICAL CONTROL JOINT DETAIL**  
SCALE 1:10

'DANLEY KEY JOINT' WITH PERMANENT CAPPING STRIP (OR APPROVED EQUIVALENT) INSTALLED TO MANUFACTURERS RECOMMENDATIONS. (SHOWN)

OR

25mm DEEP SAWN / TOOLED JOINT WITH EVERY 2<sup>nd</sup> BAR CUT ACROSS JOINT IN REINFORCING MESH. NOTE SLAB THICKENING NOT REQUIRED WHEN USING THIS OPTION.

'DANLEY PAVEX EXPANDA HD (OR APPROVED EQUIVALENT) INSTALLED TO MANUFACTURERS RECOMMENDATIONS.

OR

FULL DEPTH CLOSED CELL CROSS LINKED POLYETHYLENE FOAM (85-150 kg/m<sup>3</sup>) WITH SUITABLE SILICONE SEALANT TO PREVENT INGRESS OF DIRT. (SHOWN)

STOP MESH

10mm

DOWEL (REFER NOTE 5)

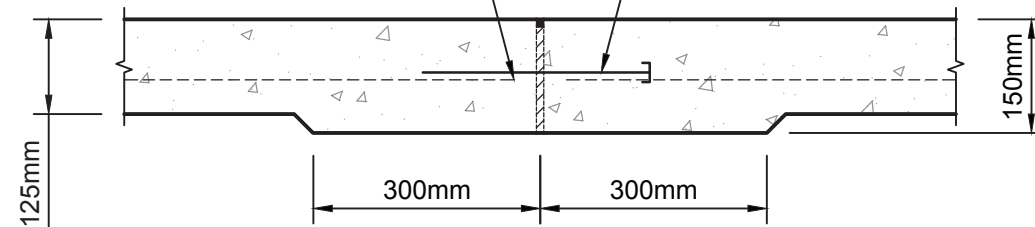

**TYPICAL EXPANSION JOINT DETAIL**  
SCALE 1:10

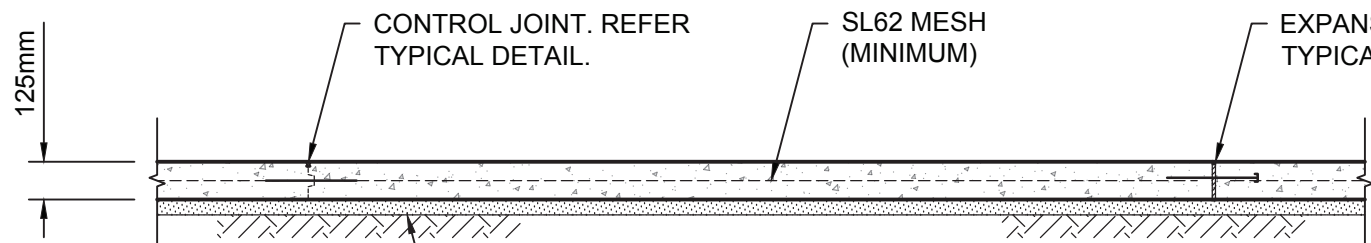

COMPACTED SUBGRADE

- 50mm COMPACTED DEPTH CRUSHER DUST

OR

- WHERE HIGHLY EXPANSIVE SOILS ARE PRESENT, PLACE 100mm COMPACTED DEPTH TYPE 2.4 GRAVEL (TO BE DIRECTED BY SUPERINTENDENT)

**SECTION A-A**  
SCALE 1:25

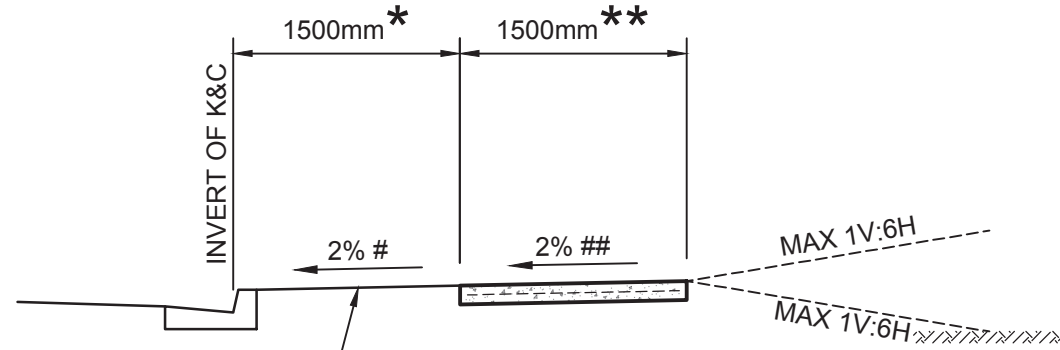

MAX 1V:6H WHERE NO K&C PRESENT

**SECTION B-B**  
SCALE 1:50

# 2% PREFERRED CROSS FALL  
MAX & MIN LIMITS - REFER STANDARD DWG NO. A3-00773

## FOOTPATH CROSS FALL  
2% PREFERRED  
1% ABSOLUTE MINIMUM  
2.5% ABSOLUTE MAXIMUM

\* 1500 PREFERRED WIDTH. WHERE SITE CONSTRAINTS RESULT IN A TURF WIDTH LESS THAN 400, WIDEN CONCRETE FOOTPATH TO JOIN K&C

\*\* 1500 PREFERRED FOOTPATH WIDTH UNLESS NOMINATED OTHERWISE ON PROJECT DRAWINGS

### ASSOCIATED DRAWINGS:

A3-00773 STANDARD INVERT TYPE CROSSING FOR KERB AND CHANNEL

A3-00989 STANDARD : CITY CENTRE FOOTPATH, TYPE 2 - PAVER

A3-00848 STANDARD : FOOTPATH TREATMENT TO CBD PERIPHERY AREAS

A2-00576 STANDARD KERB RAMP, PLAN & SECTIONS

SUPERINTENDENT SHALL ADVISE THE CONTRACTOR WHETHER HAND EXCAVATION IS TO BE ADOPTED OR WHETHER THE LEVELS IN THE VICINITY OF THE TREE SHOULD BE ADJUSTED TO PROTECT THE ROOTS. WHERE THE CONCRETE FOOTPATH CANNOT BE CONSTRUCTED WITHIN THE SPECIFIED CONSTRAINTS, THE CONTRACTOR SHALL CONTACT THE SUPERINTENDENT.

- THE PROPOSED CONCRETE FOOTPATH ALIGNMENT SHALL BE APPROVED ON SITE, PRIOR TO EXCAVATION.
- WHERE CONCRETE FOOTPATH IS CONSTRUCTED OVER A WATER MAIN, INSTALL A BRASS BOLTED TRAP SCREW INTO SLAB OVER ALL WATER MAIN COCK IN THE CONSTRUCTION FOOTPRINT.
- THE EXISTING PROPERTY DRAINAGE PIPES SHALL BE LEFT IN PLACE EXCEPT WHERE CRACKED/DAMAGED. DAMAGED PIPES SHALL BE REPLACED FROM THE BACK OF KERB THROUGH TO THE PROPERTY BOUNDARY. WHERE PIPES HAVE <40mm COVER, INSTALL CONTROL JOINT OVER PIPE.
- WHERE SURVEY PINS ARE ENCOUNTERED, PINS SHALL BE EXPOSED BY HAND AND A BOLTED TRAP SCREW SET INTO THE CONCRETE FOOTPATH ABOVE THE PIN.
- THIS DRAWING IS NOT TO BE USED FOR THE CONSTRUCTION OF CONCRETE FOOTPATHS WITHIN THE MACKAY CENTRAL BUSINESS DISTRICT. REFER LOCALITY PLAN STD DWG A3-00989.
- ALL DIMENSIONS IN MILLIMETRES, UNLESS NOTED OTHERWISE.

### FOOTPATH NOTES:

- REINFORCING MESH TO COMPLY WITH AS4671, LAP MESH 400mm, 50mm TOP AND EDGE COVER, UNLESS OTHERWISE SPECIFIED.
- REINFORCEMENT BAR CHAIRS (PLASTIC ACCEPTED) ARE TO BE USED TO ACCURATELY LOCATE MESH. PLACE CHAIRS AT 500mm MAXIMUM CENTRES IN A TRIANGULAR PATTERN. BAR CHAIR DIMENSIONS ARE TO BE SELECTED TO CENTRALISE REINFORCING MESH IN THE SLAB.
- REINFORCING MESH CAN BE REPLACED WITH FIBRE REINFORCED CONCRETE (FRC). USE OF FRC SHALL NOT REMOVE NEED FOR EXPANSION/CONTROL JOINTS. NEW RESIDENTIAL OR COMMERCIAL/INDUSTRIAL CROSSINGS ARE TO BE REINFORCED WITH F82 MESH, 50mm TOP AND EDGE COVER, UNLESS OTHERWISE NOTED. IN MRC PARKS AND NATURE RESERVES, FOOTPATHS ARE TO BE CONSTRUCTED, ONLY, WITH REINFORCING MESH. NO FIBRE WILL BE ACCEPTED.
- FIBRE REINFORCING DOSAGE RATES OF PPM 48/19 FIBRES OR EQUIVALENT SHALL BE 2.3kg/m<sup>3</sup> FOR DEPTHS 125mm AND 150mm.
- DOWELS TO BE 12 DIA GALVANISED STEEL BARS, GRADE 250R, 300mm LONG AT 300 CENTRES. BAR TO BE SAW CUT, NOT SHEARED, TO PERMIT MOVEMENT. GREASE ONE END OF DOWEL & ATTACH DOWEL CAP.
- CONCRETE N32 TO BE USED AND COMPLY WITH AS1379 AND AS3600, WITH SLUMP OF 80mm, UNLESS OTHERWISE SPECIFIED, TOGETHER WITH MRS03, MRS70 & RELEVANT MRC SUPPLEMENTARY SPECIFICATIONS.
- ALL CONCRETE SHALL BE SPRAYED WITH AN APPROVED CURING PRODUCT AND BROOM FINISHED PERPENDICULAR TO PEDESTRIAN TRAVEL.
- FINISHED SURFACE TOLERANCE TO BE MAXIMUM +5mm/-0mm RELATIVE TO KERB LEVEL AND CROSS FALL SPECIFIED TO ENSURE WATER WILL NOT POND.
- PROVIDE AN EXPANSION JOINT AT BOTH SIDES OF NEW RESIDENTIAL OR COMMERCIAL/INDUSTRIAL CROSSINGS, REINFORCED WITH SL82 MESH, 50mm TOP AND EDGE COVER, UNLESS OTHERWISE SPECIFIED. PROPRIETARY DANLEY/CONNOLLY EXPANSION JOINTS OR EQUIVALENT MAY ALTERNATELY BE UTILISED.
- CONCRETE FOOTPATHS ADJOINING EXISTING CROSSINGS ARE TO BE TRANSITIONED HORIZONTALLY AND VERTICALLY OVER A 5.0m MINIMUM LENGTH, UNLESS OTHERWISE SPECIFIED. THE VERTICAL GRADE OF THE TRANSITIONED SECTION IS NOT TO EXCEED 1:14 UNLESS OTHERWISE APPROVED. PROVIDE AN EXPANSION JOINT AT BOTH SIDES OF EXISTING CROSSING AND EXISTING STRUCTURES.
- WHERE THE EXISTING CROSSING, ADJOINING A PROPOSED CONCRETE FOOTPATH, DOES NOT SATISFY COUNCIL'S REQUIREMENTS, THE SUPERINTENDENT MAY MODIFY THE CROSSING TO ACHIEVE THE BEST POSSIBLE OUTCOME. BEFORE ANY MODIFICATION IS MADE TO AN EXISTING CROSSING, THE SUPERINTENDENT MUST DISCUSS THE PROPOSED WORKS, INCLUDING THE PROPOSED SURFACE, WITH THE LANDOWNER.
- PLACE 30mm OF TOPSOIL AND TURF TO DISTURBED AREAS ADJOINING NEW CONCRETE FOOTPATHS, UNLESS OTHERWISE SPECIFIED. REINSTATED AREAS ARE TO BE GRADED EVENLY. CRUSHER DUST IS NOT TO BE USED FOR REINSTATEMENT WORKS.
- TREE PRUNING IS TO BE CARRIED OUT BY A QUALIFIED ARBORIST. BEFORE ANY EXCAVATION IS CARRIED OUT OVER THE ROOTS OF TREES, THE

K	10/08/22	TITLEBLOCK UPDATED, DETAILS AMENDED.	Dale Stevens	Graeme Hawes	SURVEYED BY	SCALES (A2)	DRAWN	SIGNED	DATE	ASSET OWNER
J	29/10/21	NOTE 15 AMENDED - BRASS BOTTLE TAP SCREW	WM	GH	-	0 0.10 0.20 0.30 0.40m	-	-	-	-
I	01/05/20	NOTES AMENDED	SLR	GH	SURVEY FILE No	1:10	DESIGNED	SIGNED	DATE	-
H	20/11/18	NOTE 14 (REV G) REMOVED	SLR	GH	-	0 0.25 0.5 0.75 1.0m	CHECKED	SIGNED	DATE	G. HAWES
G	30/07/18	NOTE 5 AMENDED	SLR	CEB	LEVEL DATUM	1:25	-	-	-	DATE
NO.	DATE	DESCRIPTION	DRAWN	APPROVED	A.H.D.	0 0.5 1 1.5 2.0m	MANAGER / CO-ORDINATOR	-	-	CERTIFIED
AMENDMENTS AND REVISIONS					HOR. DATUM / DATE	1:50	ORIGINAL SIGNED BY J. CLARKE	27/11/03	DATE	ORIGINAL SIGNED BY S. HOLLEY
K:\Technical Services\Design\Projects\Standard drawings\FOOTPATHS\A2-00500K.dwg					MGA 2020 08/22		J. CLARKE			S. HOLLEY



## STANDARD CONCRETE FOOTPATH

SHEET 1 OF 1

WORKS JOB No. -

DRAWING No.

A2-00500

AMEND.

K