

Correct street addressing

Simple guide to minor residential street addressing

Correct street addressing is essential for easy identification for emergency services. The requirements for the assignment of street addressing are set out in AS/NZ4819:2011 - Rural and Urban Addressing

Street addressing must:

- Be assigned as early as practicable in the development process
- Be clear, logical and sequential
- Be assigned relative to the point of access to the property
- Use alpha suffixes when additional lots are created
- Use numerical suffixes for additional dwellings
- Provide alternative street addressing on corner sites
- Utilise additional numbers if available and applicable

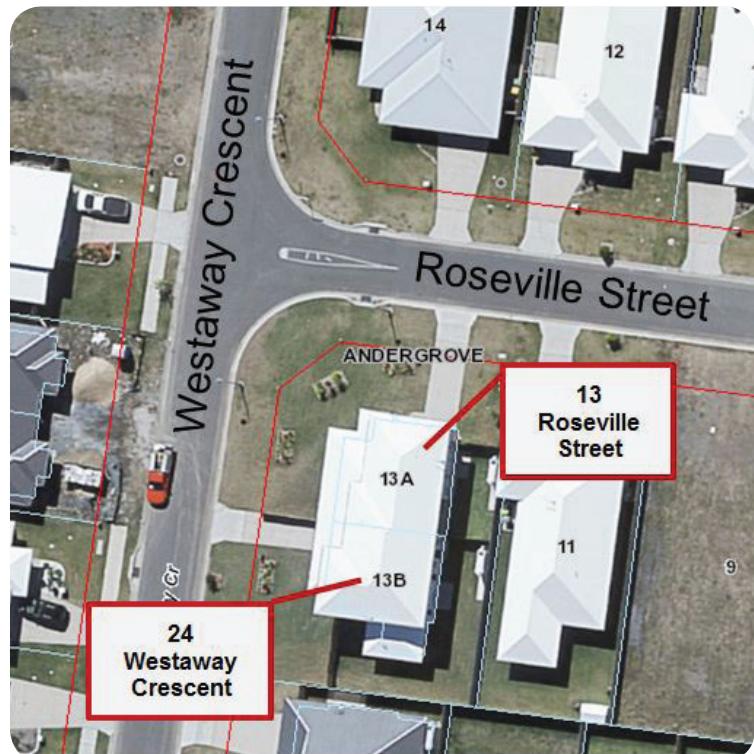

Examples of incorrect street addressing

13A & 13B Roseville Street (right) should be addressed 13 Roseville Street & 24 Westaway Crescent

This corner site enables each dwelling to gain access from a different street. Street numbering should have been issued according to the access point.

1/2 & 2/2 Galleon Circuit (below) should be addressed 1/39 and 2/39 Schooner Avenue

Both properties gain access from Schooner Avenue and yet were issued street numbering from Galleon Circuit.



Correct street addressing

The following extract is from **AS/NZ4819:2011 - Rural and Urban Addressing**

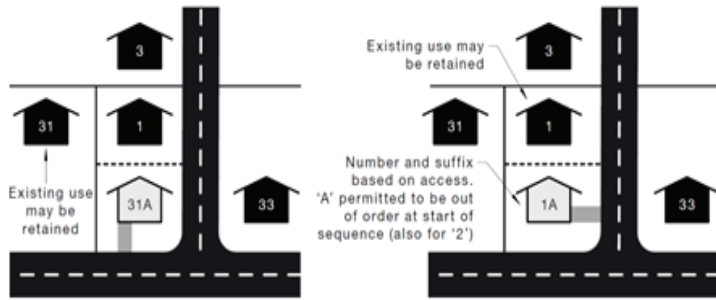

FIGURE 5.9 EXAMPLES OF SUFFIXES APPLIED TO CORNER SITES

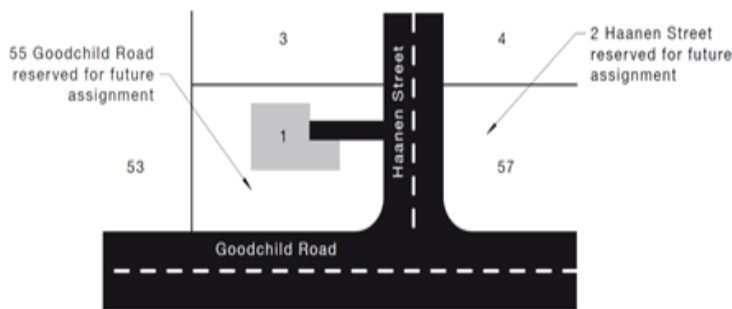
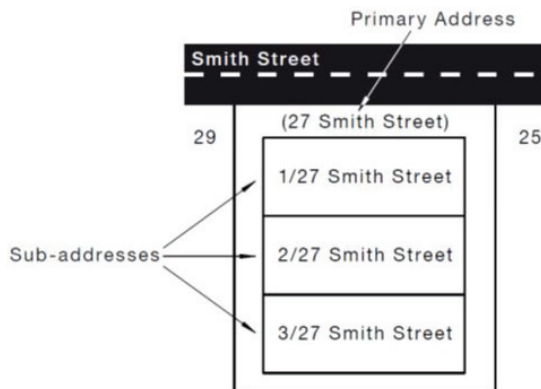

FIGURE 5.15 NUMBER ON CORNER SITE RESERVED FOR FUTURE USE



Alternative addresses

In addition to its main address, a primary address site may be assigned one or more alternative addresses where it has more than one access point.

Numbering a corner site

An address site on a corner shall be given an address number on the road with the main access point, in accordance with this Standard. An address number on the other road shall be reserved for that site to allow for future development unless it is assigned as an alternative address.

Sub addressing

Sub-address numbering shall be used for address sites that are contained within a primary address site — for example, an apartment building, block of flats, or marina.

**For more information
phone council on
1300 MACKAY
(1300 622 529)
or visit the website
mackay.qld.gov.au**